

Hybrid Stepper Motor

35BYG Series

General Specifications

Step Accuracy	± 5%
Temperature Rise	80°C Max
Ambient Temperature Range	-20°C ~ +50°C
Insulation Resistance	100 MΩ Min. 500 VDC
Dielectric Strength	500 VAC 1 minute
Customized solutions on request.	

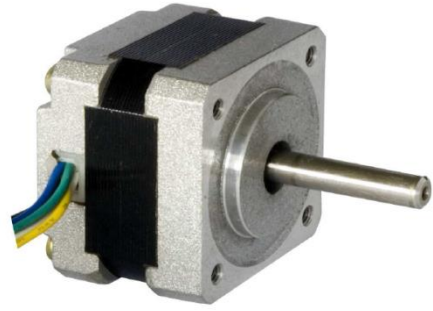

Electrical Specifications

Model	Step Angle	Motor Length	Rate Voltage	Rate Current	Phase Resistance	Phase Inductance	Holding Torque	Detent Torque	Rotor Inertia	Lead Wire	Motor Weight
	°	L (mm)	V	A	Ω	mH	mNm	mNm	gcm ²	NO.	kg
35BYG101	1.8	20	11.25	0.45	25	9	49.0	4.9	8	6	0.1
35BYG103	1.8	20	6.57	0.73	9	4	63.7	4.9	8	4	0.1
35BYG104	1.8	20	10.8	0.4	27	17	63.7	4.9	8	4	0.1
35BYG203-01	1.8	26	2.4	1.5	1.6	1.4	88.3	5.9	10	4	0.13
35BYG204-02	1.8	26	6.84	0.76	9	4.8	78.5	5.9	10	6	0.13
35BYG205-01	1.8	26	12	0.25	48	17	37.3	5.9	10	6	0.13
35BYG207-01	1.8	26	3.2	0.75	4.3	4	68.6	5.9	10	4	0.13
35BYG302-01	1.8	28	10.4	0.4	26	10	98.1	7.8	11	6	0.14
35BYG303-02	1.8	28	7	0.54	13	9.5	78.5	7.8	11	4	0.14
35BYG304-01	1.8	28	3.5	1	3.5	3.5	122.6	7.8	11	4	0.14
35BYG401-01	1.8	34	12	0.5	24	12	98.1	9.3	13	6	0.17

Mechanical Dimensions

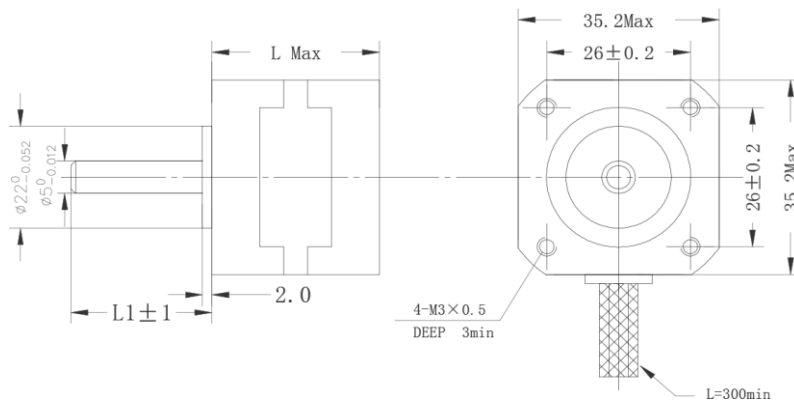

Wiring Diagram

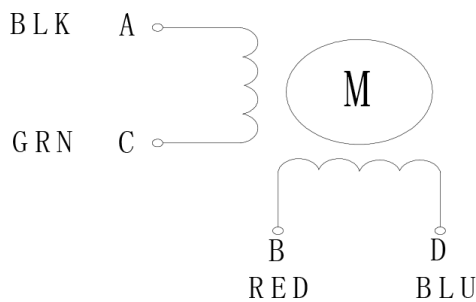

4 Leads

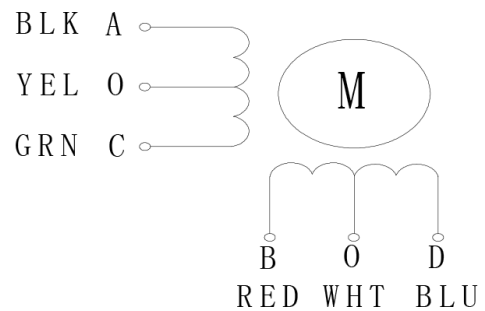

6 Leads

Hybrid Stepper Motor

Pulse-Torque Characteristics

